

SMART CLEANER LC/MU 1,25 mm Ferrule, Kapazität ca. 800 Reinigungen



One-Click Cleaner MU/LC Instruction Manual

Thank you for choosing the One-Click Cleaner MU/LC. The One-Click Cleaner MU/LC is a high-performance device designed for cleaning the ferrule end faces of MU/LC connectors. Carefully read this instruction manual before using this device. Please keep this instruction.

1. Safety precautions

	Though our device is deemed safe, improper usage or handling can still inflict injury to others.
	One-Click Cleaner MU/LC is designed to clean MU and LC connectors only. It is not liable for damage caused in attempt to apply this device to other applications.

2. Notes on usage

- Do not attempt to disassemble as this can cause damage to the device.
- Do not re-use cleaning cloth as this will eliminate its cleaning ability
- Do not touch the cleaning cloth as this will cause contamination
- Do not pull the cleaning cloth, use only the device body.
- Do not use this cleaning cleaner when the cloth is empty, as this can cause damage to the connector.

3. Notes on storage for extended periods

- Do not expose device to direct sunlight, high temperature or high humidity.
- The cover on the guide cap should be closed at all times when device is not in use.

4. Device construction

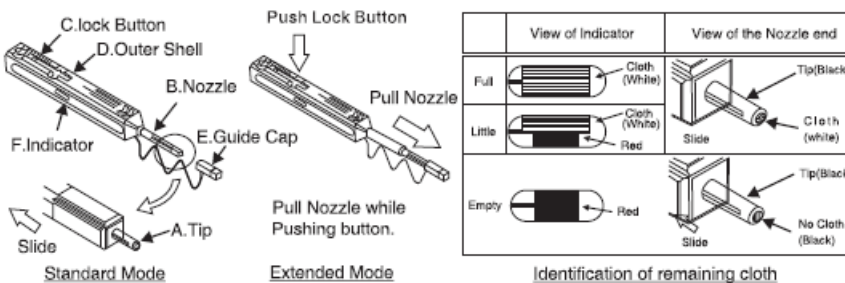

NO	Part Name	Function
A	Tip	Lead the cleaning cloth to the optical connector end face.
B	Nozzle	Lead tip to the optical connector end face.
C	Lock Button	Push the button to extend and contract the nozzle.
D	Outer Shell	Push the outer shell to clean the connector.
E	Guide Cap	Acts as dust cap or cleaning adapter for connector plug.
F	Indicator	Provides indication of remaining cleaning cloth

5.Applications

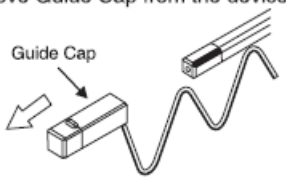
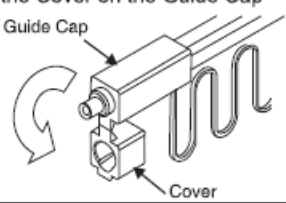
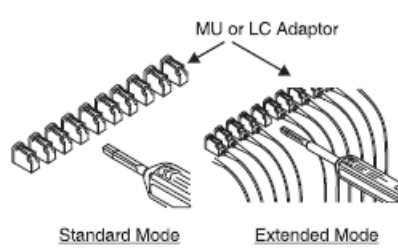
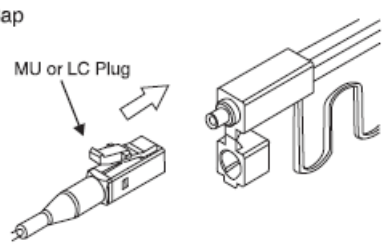
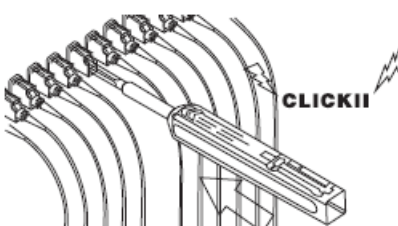
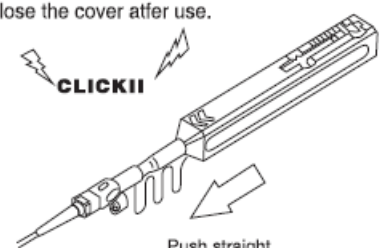
<p><Connector inside adaptor> 1.Remove Guide Cap from the device</p>  <p>Guide Cap</p>	<p><Connector plugs alone> 1.Open the Cover on the Guide Cap</p>  <p>Guide Cap Cover</p>
<p>2.Insert tip of cleaner into MU/LC Adaptor</p>  <p>MU or LC Adaptor Standard Mode Extended Mode</p>	<p>2.Insert MU/LC connector into the Guide Cap</p>  <p>MU or LC Plug</p>
<p>3.Push the Outer Shell to start cleaning the MU/LC connector end face. A "click" sound indicates end of cleaning process. Close the cover after use.</p>  <p>CLICK!</p> <p>Be careful not to slant the One-Click Cleaner MU/LC while inserting into the adapter. Do not overly exert force during insertion as this may cause damage to both the connector and the One-Click Cleaner MU/LC. If pushing Outer Shell is inhibited, remove One-Click Cleaner MU/LC from adapter and ensure that there is no sizeable debris inhibiting the cleaning process.</p>	<p>3.Push the Outer Shell to start cleaning the MU/LC connector end face. A "click" sound indicates end of cleaning process. Close the cover after use.</p>  <p>CLICK!</p> <p>Push straight.</p> <p>Be careful not to slant the MU/LC connector while inserting into the Guide cap. Do not overly exert force during insertion as this may cause damage to both the connector and the One-Click Cleaner MU/LC. If pushing Outer Shell is inhibited, remove One-Click Cleaner MU/LC from adapter and ensure that there is no sizeable debris inhibiting the cleaning process.</p>

Artikelnummer

6100100777